

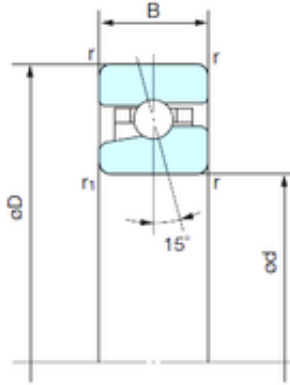

INA BRAINGS SALES JAPAN CO.,LTD.

100 mm x 150 mm x 24 mm NACHI BNH 020
angular contact ball bearings



Bearing No. BNH 020

Size	100x150x24 mm
Bore Diameter	100 mm
Outer Diameter	150 mm
Width	24 mm
d	100 mm
D	150 mm
B	24 mm
C	24 mm
Angle (°)	15 °
r min.	1.5 mm
r1 min.	1 mm
Basic dynamic load rating (C)	48 kN
Basic static load rating (C0)	56,5 kN
(Grease) Lubrication Speed	9600 r/min

BNH 020 Bearing 2D drawings and 3D CAD models